

ANEXA 4 LA HCL

Plan de amplasament si delimitare a imobilului
Scara 1:1000

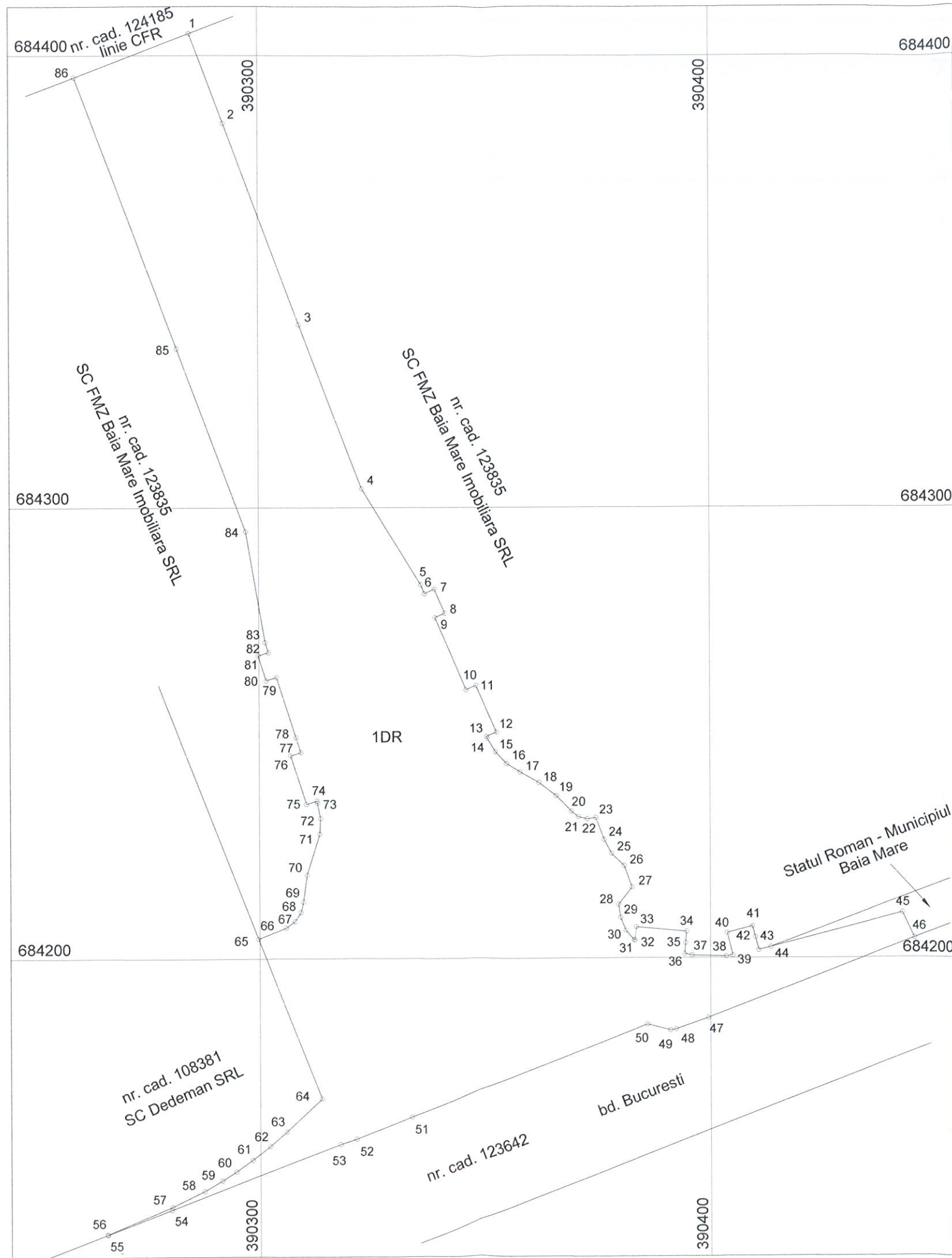

Nr. cadastral	Suprafata masurata, [mp]	Adresa imobilului
	11162	mun. Baia Mare, jud. Maramures
Nr. Cartea Funciara		Unitatea Administrativ Teritoriala (UAT)
		BAIA MARE

d 1 - 2 = 21.22 m	d 30 - 31 = 2.75 m	d 59 - 60 = 3.69 m
d 2 - 3 = 47.53 m	d 31 - 32 = 0.24 m	d 60 - 61 = 4.46 m
d 3 - 4 = 38.84 m	d 32 - 33 = 2.93 m	d 61 - 62 = 4.98 m
d 4 - 5 = 25.03 m	d 33 - 34 = 11.30 m	d 62 - 63 = 4.80 m
d 5 - 6 = 2.08 m	d 34 - 35 = 2.50 m	d 63 - 64 = 10.77 m
d 6 - 7 = 2.39 m	d 35 - 36 = 2.43 m	d 64 - 65 = 38.08 m
d 7 - 8 = 5.80 m	d 36 - 37 = 1.68 m	d 65 - 66 = 6.57 m
d 8 - 9 = 2.37 m	d 37 - 38 = 7.60 m	d 66 - 67 = 2.47 m
d 9 - 10 = 17.50 m	d 38 - 39 = 1.48 m	d 67 - 68 = 2.39 m
d 10 - 11 = 2.37 m	d 39 - 40 = 5.13 m	d 68 - 69 = 2.43 m
d 11 - 12 = 11.30 m	d 40 - 41 = 5.80 m	d 69 - 70 = 5.98 m
d 12 - 13 = 2.37 m	d 41 - 42 = 2.50 m	d 70 - 71 = 9.52 m
d 13 - 14 = 0.43 m	d 42 - 43 = 2.96 m	d 71 - 72 = 3.47 m
d 14 - 15 = 3.48 m	d 43 - 44 = 2.79 m	d 72 - 73 = 3.53 m
d 15 - 16 = 3.62 m	d 44 - 45 = 30.06 m	d 73 - 74 = 0.44 m
d 16 - 17 = 3.55 m	d 45 - 46 = 6.16 m	d 74 - 75 = 2.37 m
d 17 - 18 = 4.74 m	d 46 - 47 = 48.88 m	d 75 - 76 = 11.30 m
d 18 - 19 = 4.75 m	d 47 - 48 = 7.62 m	d 76 - 77 = 2.37 m
d 19 - 20 = 4.85 m	d 48 - 49 = 1.30 m	d 77 - 78 = 3.45 m
d 20 - 21 = 1.98 m	d 49 - 50 = 5.26 m	d 78 - 79 = 14.05 m
d 21 - 22 = 1.96 m	d 50 - 51 = 56.23 m	d 79 - 80 = 2.37 m
d 22 - 23 = 1.95 m	d 51 - 52 = 13.23 m	d 80 - 81 = 5.80 m
d 23 - 24 = 5.20 m	d 52 - 53 = 3.73 m	d 81 - 82 = 2.37 m
d 24 - 25 = 3.53 m	d 53 - 54 = 40.20 m	d 82 - 83 = 2.34 m
d 25 - 26 = 3.87 m	d 54 - 55 = 15.30 m	d 83 - 84 = 24.95 m
d 26 - 27 = 5.06 m	d 55 - 56 = 0.11 m	d 84 - 85 = 43.31 m
d 27 - 28 = 4.86 m	d 56 - 57 = 15.70 m	d 85 - 86 = 64.03 m
d 28 - 29 = 2.93 m	d 57 - 58 = 8.03 m	d 86 - 1 = 27.30 m
d 29 - 30 = 3.11 m	d 58 - 59 = 4.58 m	



A. Date referitoare la teren			
Nr. parcela	Categorie de folosinta	Suprafata [mp]	Mentiuni
1	DR	11162	Intravilan. Neimprejmuit.
TOTAL		11162	Coridor de expropriere - Tronson 3.
B. Date referitoare la constructii			
Cod constructie	Destinatia	Supraf. constr. la sol, [mp]	Mentiuni
-	-	-	-
TOTAL		-	-

Suprafata totala masurata a imobilului = 11162 mp
Suprafata din act = 11162 mp

Executant **S.C. TOPO EXPERT S.R.L.**
ing. Ardelean Vasile Alexandru

Confirm executarea masuratorilor la teren, corectitudinea informarii documentatiei cadastrale si corespondenta acesteia cu realitatea din teren

Semnatura si stampila

Inspector

Confirm introducerea imobilului in baza de date integrata si atribuirea numarului cadastral

Semnatura si parafa

Stampila BCPI

Data: 19.03.2019

Data.....